

33001 33mm三孔分水阀芯

33mm diverter cartridge

阀芯技术参数

Technical Characteristics of The Cartridge

旋转角度：360°

Max Cold/Hot turning angel : 360°

最高使用温度：90°C

Max temperature : 90°C

建议锁紧力矩：6~8Nm

Tightness of hex nut torque : 6~8Nm

操作力矩：0.15~0.30Nm (任何水温)

Operation torque : 0.15~0.30Nm
(Under any water temp)

爆破压：≥25bar

Burst pressure : ≥25bar

3bar水压下流量值：≥28L/min

Flow rate at 3bar : ≥28L/min

寿命测试：GB18145-2014 30,000cycles
EN817 : 2008 30,000cycles

Life cycle test : GB18145-2014 30,000cycles
EN817 : 2008 30,000cycles



认证

Certification

ACS

分水阀 Diverter

满足您对水龙头安全舒适的用水需求
In YJ Cartridge we make cartridges right

安装尺寸图

Drawings of Mounting Dimensions

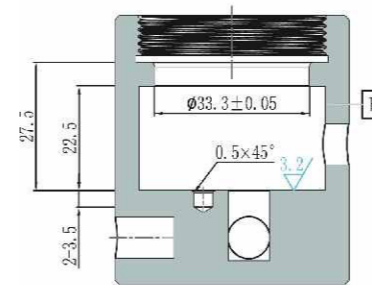
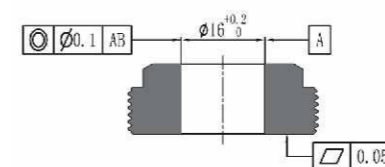
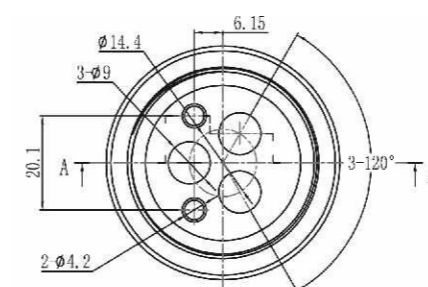

A - A

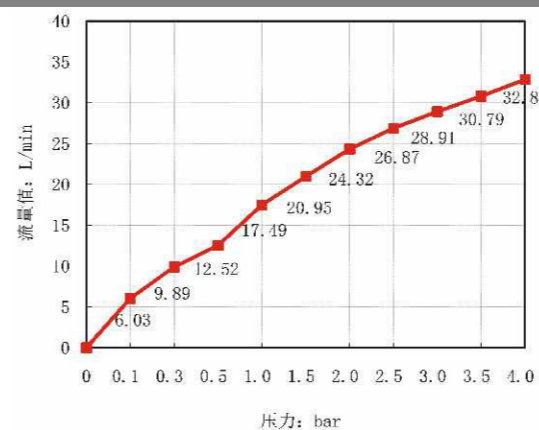
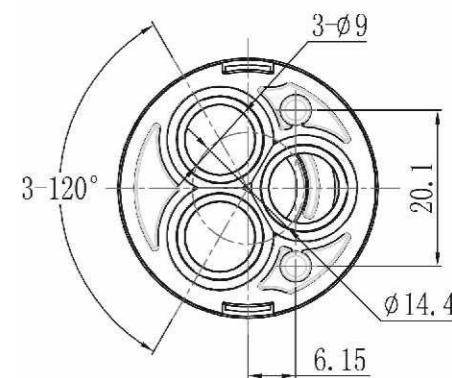
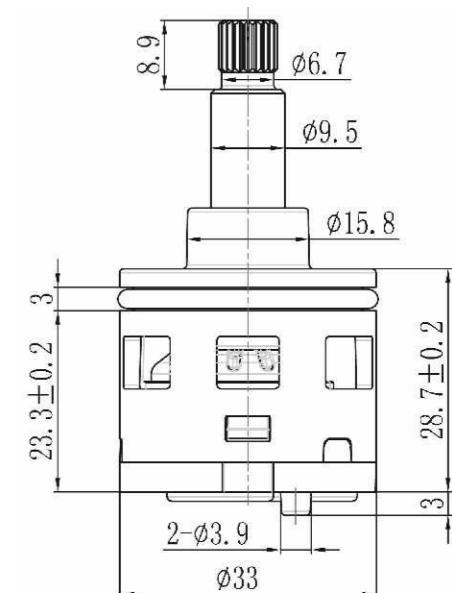

流量图
Flow Rate Curves

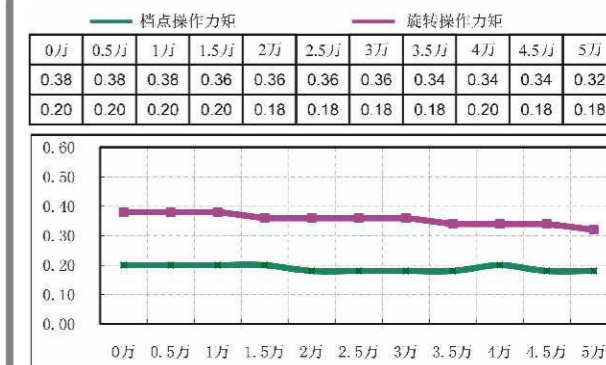

寿命测试与操作力矩图
Life test and Operation torque Curves